

| Connection hoses and cables |        |
|-----------------------------|--------|
| Water hose:                 | ✓      |
| Waste water hose:           | ✗      |
| Electric cable:             | ✓ 15 m |

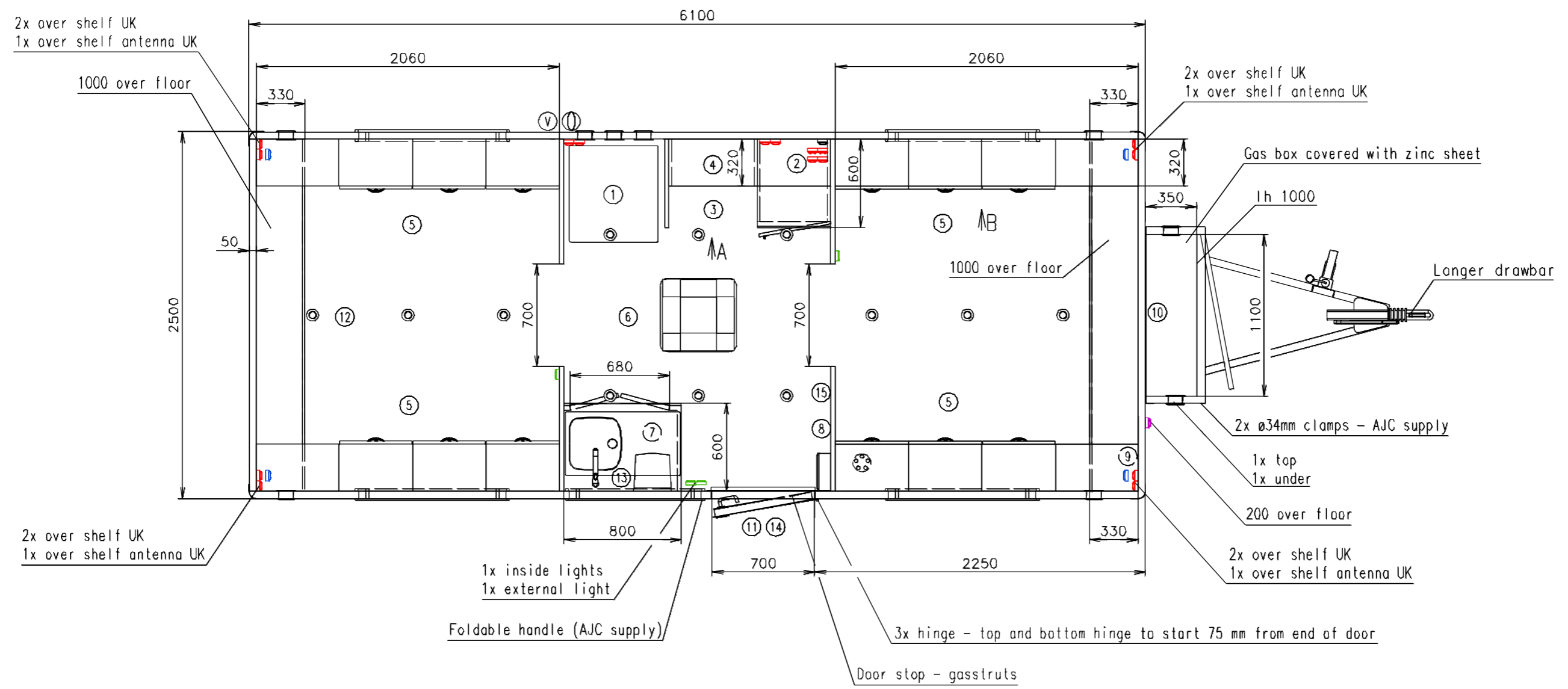

- Gas piping bonde to fuse board
- TV outlet-4x cable to the position 9 in the front right corner of wagon on the floor, splitter AJC supply
- Carpet in front and rear room - like 1765-61, CZ supply

Notes: Special windows - will not be mounted by Eurowagon

|                  |   |                                  |         |
|------------------|---|----------------------------------|---------|
| Interior height: | 2100 mm                                   | Total weight:                    | 2000 kg |
| Color:           | 2x side wall RAL 7042, otherwise RAL 9010 | Tare weight-estimate:            | 1800 kg |
| Floor:           | PVC gray                                  | Centre of wheels from rear side: | 2990 mm |
| Date:            | 16.10.2015                                | Wheels:                          | 155 R13 |

**EUROWAGON**  
 Drawing number: 2004-61-5\_1/3 (AJC)

(Cabling and piping is not shown on the 3D views and drawings)

| Connection hoses and cables |        |
|-----------------------------|--------|
| Water hose:                 | ✓      |
| Waste water hose:           | ✗      |
| Electric cable:             | ✓ 15 m |

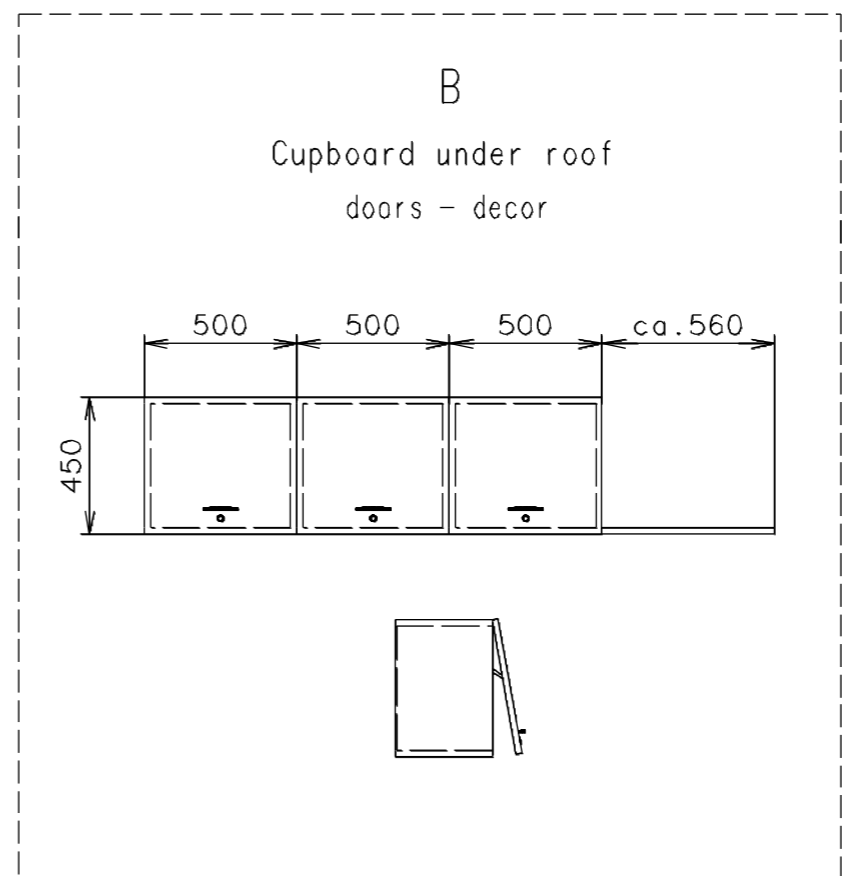
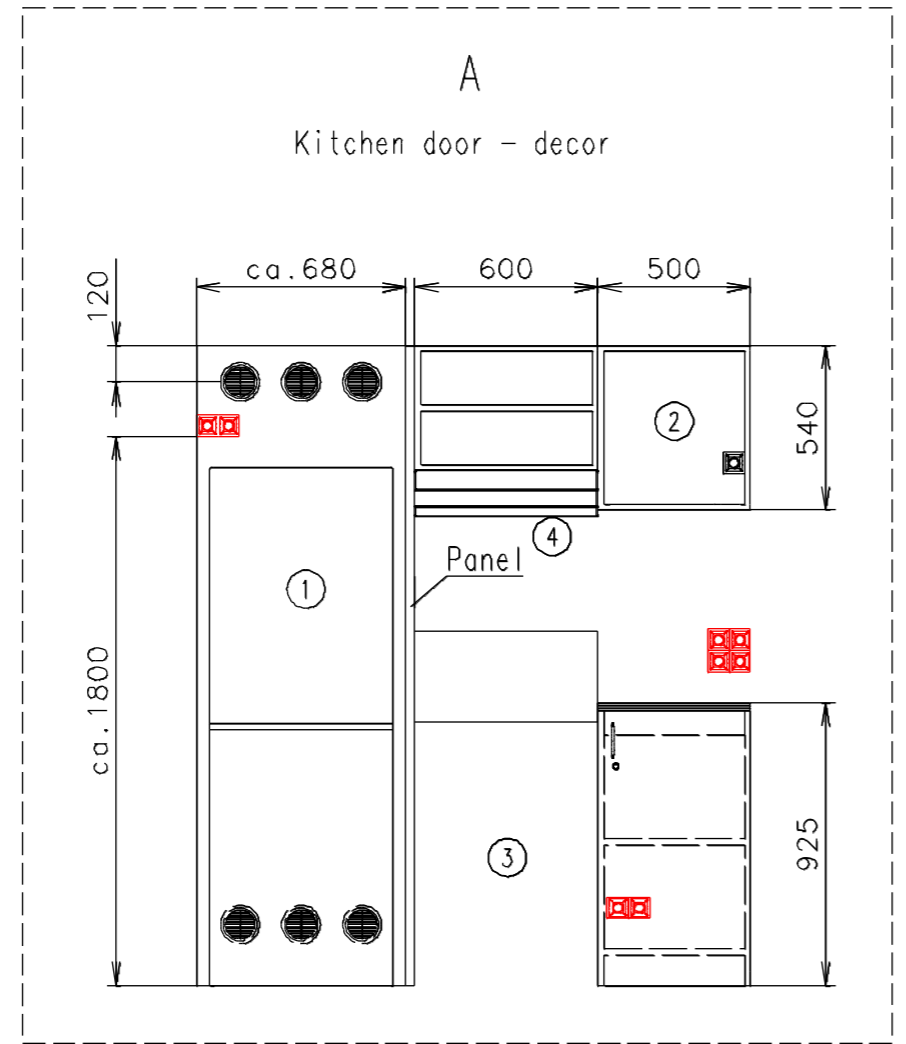

Gas piping bonde to fuse board

TV outlet-4x cable to the position 9 in the front right corner of wagon on the floor, splitter AJC supply

Carpet in front and rear room - like 1765-61, CZ supply

Notes: Special windows - will not be mounted by Eurowagon



|                  |   |                                  |         |
|------------------|---|----------------------------------|---------|
| Interior height: | 2100 mm                                   | Total weight:                    | 2000 kg |
| Color:           | 2x side wall RAL 7042, otherwise RAL 9010 | Tare weight-estimate:            | 1800 kg |
| Floor:           | PVC gray                                  | Centre of wheels from rear side: | 2990 mm |
| Date:            | 16.10.2015                                | Wheels:                          | 155 R13 |

(Cabling and piping is not shown on the 3D views and drawings)

**EUROWAGON**

Drawing number:  
2004-61-5\_2/3 (AJC)

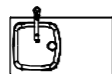
| Connection hoses and cables |        |
|-----------------------------|--------|
| Water hose:                 | ✓      |
| Waste water hose:           | ✗      |
| Electric cable:             | ✓ 15 m |

- Ⓥ Water connection 3/4" (on the chassis)
- Ⓛ Effluent connection (under floor), connection point AJC supply
- Ⓜ Electric connection (on the chassis) (230V-32A)
- Ⓧ Power point
- Ⓨ Double power point - UK
- Ⓩ TV outlet - UK
- ⓐ TV inlet - UK
- ⓑ Light switch
- ⓓ Switch board (under roof)
- ⓔ Spot light
-  Kitchen sink with drainer Alveus Basic 150 + standard water tap
-  Hot water boiler Gorenje GT50 (5 l) - through IP switch (UK) directly to switch board
-  Roof window Dometic (400x400)
- ⓖ Ventilation ø120

- ▬ Shelf
- ① Fridge Indesit BIAA 12P - connection point AJC supply
- ② Microwave
- ③ Cooker hood
- ④ Place for gas cooker - AJC supply
- ⑤ Place for bed
- ⑥ Smoke detector - on the roof
- ⑦ 12V water pump - through IP switch (UK) directly to switch board + transformer - AJC supply
- ⑧ Heating - through power point " fused spur" (UK) - AJC supply
- ⑨ Cabling from TV outlet on the floor + splitter AJC supply
- ⑩ Gas regulator (AJC supply)
- ⑪ Standard free standing stairs
- ⑫ Spare wheel on the chassis
- ⑬ Heating (under roof) - through power point " fused spur" (UK) - AJC supply
- ⑭ External LED light 320/636 - through light switch beside door
- ⑮ Fire extinguisher (on the wall) - AJC supply

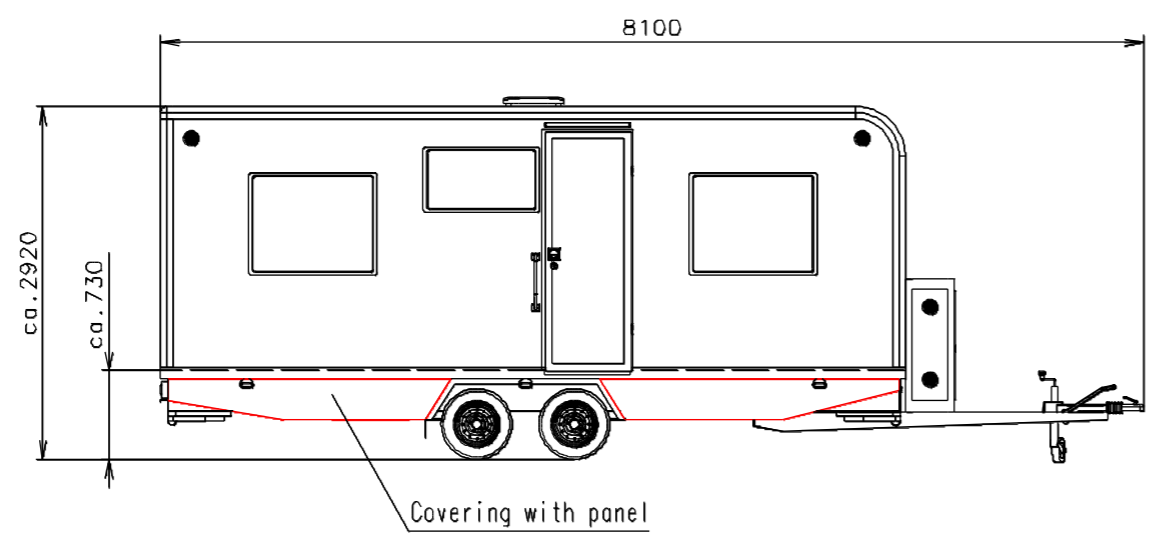

(Cabling and piping is not shown on the 3D views and drawings)

- Gas piping bonde to fuse board
- TV outlet-4x cable to the position 9 in the front right corner of wagon on the floor, splitter AJC supply
- Carpet in front and rear room - like 1765-61, CZ supply

Notes: Special windows - will not be mounted by Eurowagon

|                  |   |                                  |         |
|------------------|---|----------------------------------|---------|
| Interior height: | 2100 mm                                   | Total weight:                    | 2000 kg |
| Color:           | 2x side wall RAL 7042, otherwise RAL 9010 | Tare weight-estimate:            | 1800 kg |
| Floor:           | PVC gray                                  | Centre of wheels from rear side: | 2990 mm |
| Date:            | 16.10.2015                                | Wheels:                          | 155 R13 |

**EUROWAGON** Drawing number: 2004-61-5\_3/3 (AJC)